



**For Sublease**  
15,948 SF  
89% Warehouse  
11% Office

# 88 Black Falcon Avenue Raymond Flynn Marine Park Boston

- Suite 120/126
- Term through 12/8/2029
- On-site amenities include fitness, a cafe, and bicycle sharing
- Six dedicated tailboard docks with a  $\pm 125'$  truck court
- Seven dedicated/reserved vehicle parking spots plus access to visitor spots
- 16'-18' clear height
- Electrical power: 3 Phase-4 Wire with 480/277 volts
- Steps to Seaport amenities and mere moments from Conley Terminal
- Easy access to I-90, I-93, Logan Airport and South Station via the MBTA Silver Line

**For more information**

**JP Plunkett**  
**Principal**

e: [plunkett@r-dome.com](mailto:plunkett@r-dome.com)

m: 617 999 4993

**Warren Brown**  
**Senior Director**

e: [warren@bostoncommercialproperties.com](mailto:warren@bostoncommercialproperties.com)

m: 617 962 8337



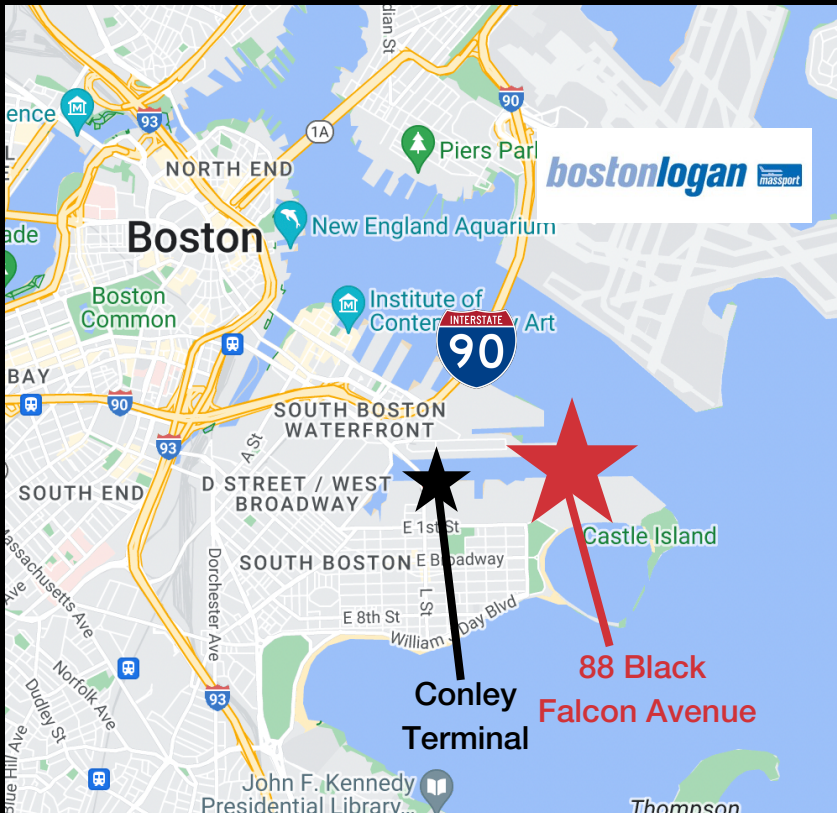
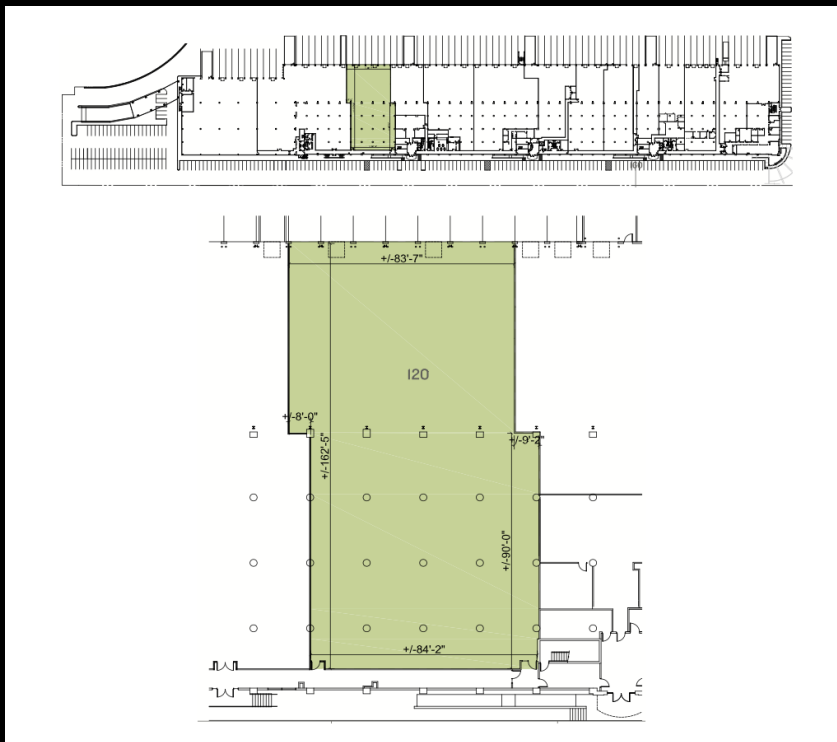

Professionally managed by  DAVIS

JP Plunkett

A Member of  NAI Global Unlimited

540 Gallivan Boulevard, Suite 206, Boston, MA 02124

 [www.r-dome.com](http://www.r-dome.com)

 @reddomerealty

ALL MATERIAL PRESENTED HEREIN IS FOR INFORMATIONAL PURPOSES ONLY. INFORMATION IS COMPILED FROM SOURCES DEEMED RELIABLE BUT IS SUBJECT TO ERRORS, OMISSIONS, CHANGES OR WITHDRAWAL WITHOUT NOTICE. RED DOME LLC NOR ITS AFFILIATES ASSUME ANY LIABILITY IN ANY FASHION AT ALL